

# **USER MANUAL**

## **PORTABLE COMPRESSOR FRIDGE**

### **12/24V Fridge/Freezer**

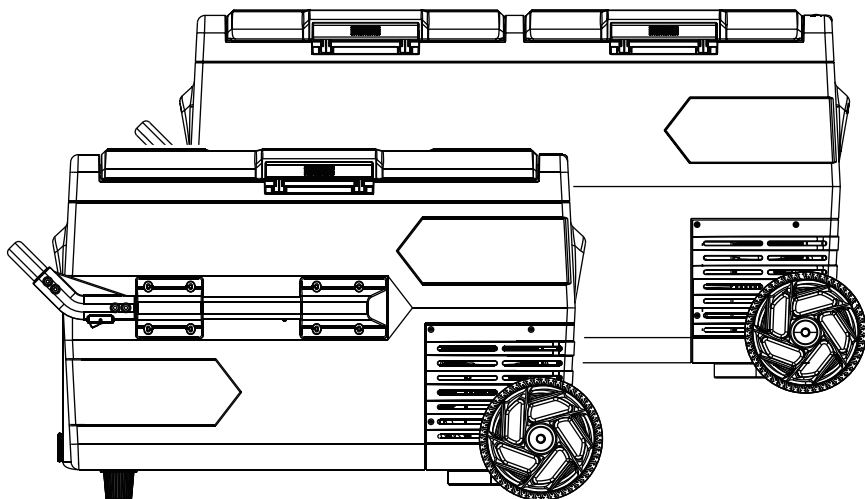

**SINGLE ZONE:DSP-50AY1(MK)&DSP-65AY1(MK)**  
**DUAL ZONE:DSP-75AY1(MK)&DSP-95AY1(MK)**

Please read and understand this manual completely  
before using this product.

# SAFETY INFORMATION



## NOTICE

Please read the user manual and safety instructions carefully before using the appliance.

- ♦ By ignoring the safety instructions, the manufacturer cannot be held responsible for the damage.
- ♦ The use of accessories that are not recommended by manufacturer can cause injuries and will invalidate any warranty that you may have.
- ♦ The appliance shall not be exposed to moderate/heavy rain.
- ♦ Place the refrigerator on a dry, secure surface, with adequate ventilation.
- ♦ Do not leave the refrigerator unattended in uncovered, outdoor areas exposed to the elements.
- ♦ Do not use this appliance near direct heat sources, such as an open flame or radiator.
- ♦ Do not place open containers of liquid inside the fridge.
- ♦ Please don't put hot/warm food into the fridge directly without letting it cooling off. Place/arrange the content of your fridge securely when using the refrigerator inside a moving vehicle.
- ♦ To maximize energy savings, please make sure the lid is closed and secure, and only open the fridge when you need to.
- ♦ The power cable must only be replaced by qualified technical personnel and by an assistant body authorized by the manufacturer.
- ♦ Before carrying out any maintenance operations on the refrigerator, disconnect all power sources from the fridge.
- ♦ Further information is provided on the technical data label inside the product.



## CAUTION

- Please keep the fridge in a well ventilated area.
- Do not use mechanical devices or other means to accelerate the defrosting process, other than those recommended by the manufacturer.
- Do not use electrical devices inside the food storage compartments of the appliance, unless approved/recommended by the manufacturer.
- It must only be supplied at safety extra low voltage corresponding to the marking on the appliance.
- To avoid contamination of food, please respect the following instructions:
  - Opening the door for long periods can cause a significant increase of the temperature in the compartments of the appliance.
  - Clean regularly surfaces that can come in contact with food and accessible drainage systems.
  - Store raw meat and fish in suitable containers in the refrigerator, so that it is not in contact with or drip onto other food.
  - If the refrigerating appliance is left empty for long periods, switch off, defrost, clean, dry, and leave the door open to prevent mould developing within the appliance.

**WARNING!** Food needs to be packed in bags before putting into the refrigerator, and liquids need to be packed in bottles or capped containers to avoid the problem that the product design structure is not easy to clean.



## **WARNING!**

- Do not store explosive items, such as aerosol cans with a flammable propellant in this appliance.
- Risk of fire and electrical shock.
- Do not let hot items touch the plastic parts of the appliance.
- Do not put flammable products or items in, near or on the appliance.
- Do not touch the compressor or the condenser when the fridge is operating. They may be very hot.
- When setting up the appliance, ensure the supply cord is not trapped or damaged.
- Do not locate multiple portable socket-outlets or portable power supplies at the rear of the appliance.
- This appliance is not intended for use by persons (including children) with reduced physical, sensory or mental capabilities, or lack of experience and knowledge, unless they have been given supervision or instruction concerning use of the appliance by a person responsible for their safety.
- Children should be supervised to ensure that they do not play with the appliance.
- If the supply cord is damaged, it must be replaced by the manufacturer, its service agent or similarly qualified person in order to avoid a hazard.
- Do not store explosive substances such as aerosol cans with a flammable propellant in this appliance.
- Two-star frozen-food compartments are suitable for storing pre-frozen food, storing or making ice-cream and making ice cubes.
- One-, two- and three-star compartments are not suitable for the freezing of fresh food.

## **CORRECT DISPOSAL OF THIS PRODUCT**



To prevent possible harm to the environment or human health from uncontrolled waste disposal, recycle it responsibly to promote the sustainable reuse of material resources. To return your used device, please use the recovery systems or contact the retailer that they can take this product for environmental safe recycling.

Risk of child entrapment.

Before you throw away your old refrigerator or freezer:

- Take off the doors.
- Leave the shelves in place so that children may not easily climb inside.

## **INTENDED TO USE**

This appliance is intended to be used in household and similar applications such as :

- staff kitchen areas in shops, offices and other working environments;
- farm houses and by clients in hotels, motels and other residential type environments;
- bed and breakfast type environments;
- catering and similar non-retail applications.
- This appliance is suitable for camping use.

# SPECIFICATIONS

SINGLE ZONE		
Model	DSP-50AY1(MK)	DSP-65AY1(MK)
Dimensions (W x D x H)	691×465×420mm	691×470×505mm
Capacity	50 L	65 L
Net Weight	19kg	21.3kg
Rated Power	65W	
Temperature Range	-20°C to +20°C	
Power Source	DC 12V/24V	
Rated Current	DC: 7.0A/3.5A	
Insulation	CFC Free PU Foam	

DUAL ZONE		
Model	DSP-75AY1(MK)	DSP-95AY1(MK)
Dimensions (W x D x H)	882x465x468mm	882x470x568mm
Capacity	75 L	95 L
Net Weight	25.5kg	27.5kg
Rated Power	65W	
Temperature Range	-20°C to +20°C	
Power Source	DC 12V/24V	
Rated Current	DC: 7.0A/3.5A	
Insulation	CFC Free PU Foam	



# SKETCH MAP OF MAIN PARTS

- |                      |                         |                    |
|----------------------|-------------------------|--------------------|
| ① Lid handle         | ⑤ Carry Handle          | ⑨ DC IN            |
| ② Cup Holder         | ⑥ Rubber Feet           | ⑩ Bracket Assembly |
| ③ Control Panel      | ⑦ Sturdy Durable Wheels |                    |
| ④ Telescoping Handle | ⑧ Air flow vent         |                    |

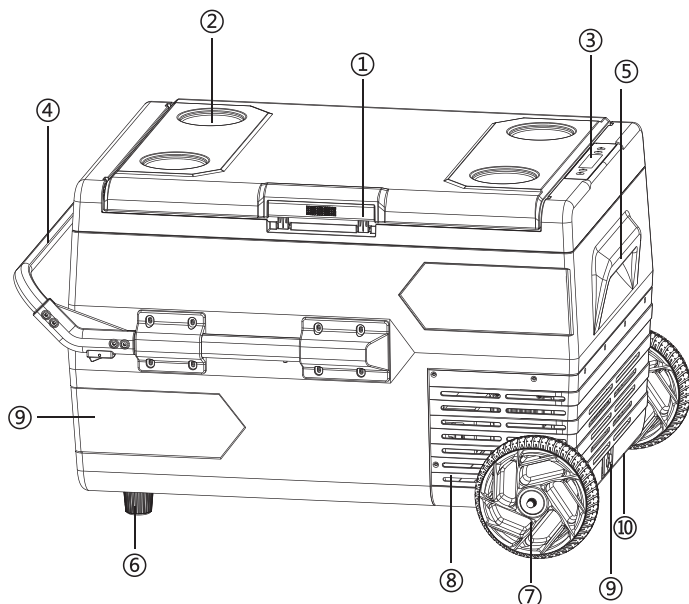

## List of attachments

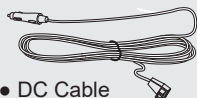

- DC Cable

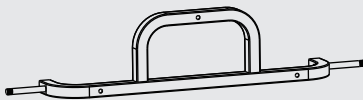

- Bracket Assembly



- Wheels x2pcs



- Rubber feet x2pcs

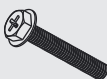

- Screws x3pcs



- screw nuts x2pcs

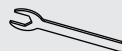

- Plate hand

# INSTALLATION INSTRUCTIONS OF ACCESSORIES

1. Install the foot on the bottom of the refrigerator.

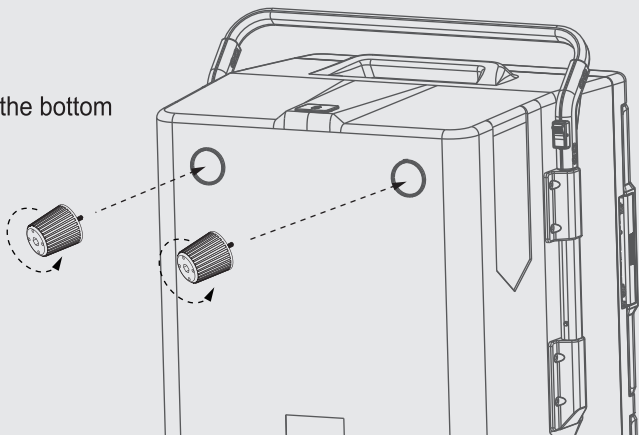

2. Install the bracket assembly at the other side of the bottom, align the bracket mounting hole with the hole position of the refrigerator, and then screw the screw into the mounting hole.

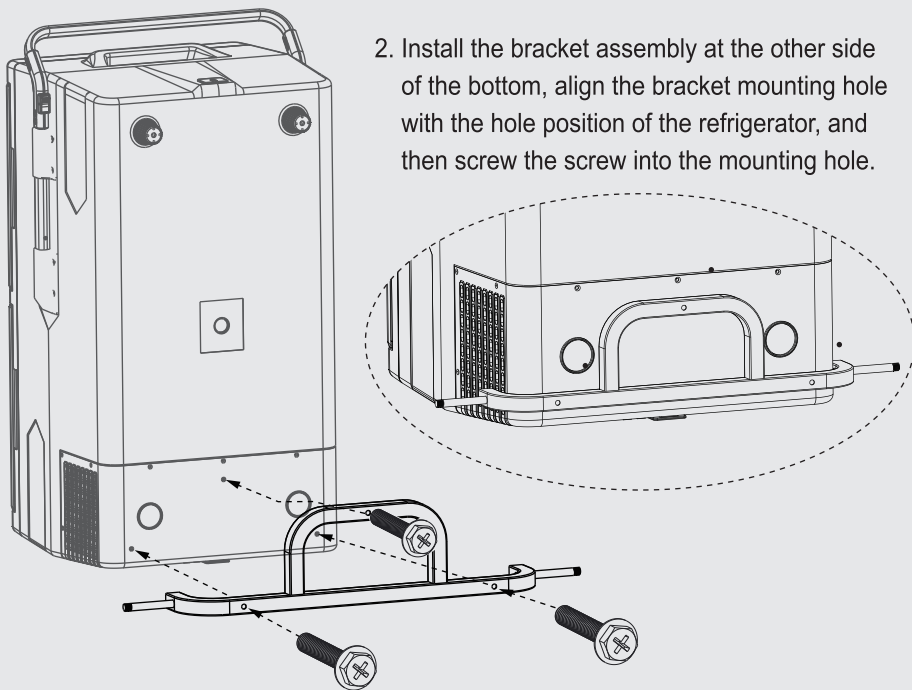

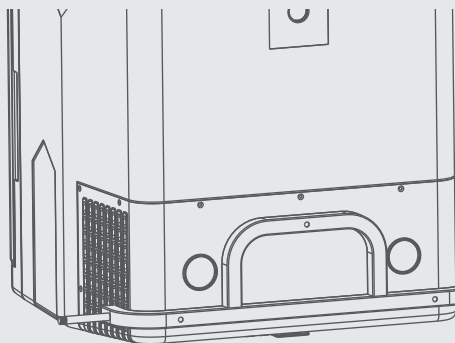

3. Insert the wheel into the left side of the bracket, then put it into the nut, and finally lock the nut with the plate hand.

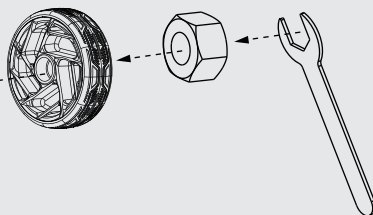

4. Repeat step 3 and install the wheel on the other side so that the refrigerator can be pulled up and slide.



**NOTICE:**

When the refrigerator is powered by battery, the inclination angle of the refrigerator should not exceed 45°.

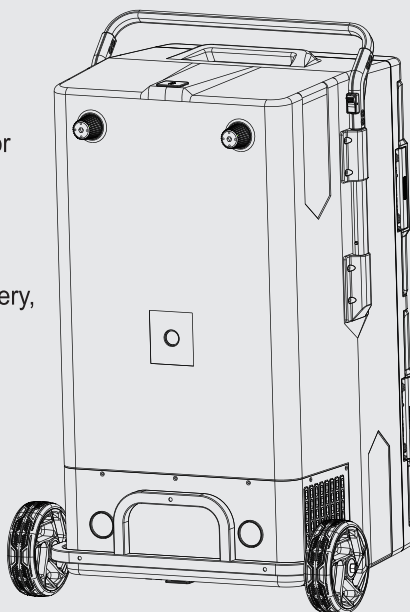

# USING THE REFRIGERATOR IN A VEHICLE

## Connecting with 12V or 24V

Connect the feeding cable to a direct current 24V DC power source.

- Make sure the polarity is right.
- If connected to an existing cigarette plug, please carefully check up that power supply is sufficient.
- If the supplied power cable is not used, please see the table containing the information related to the cable section. (The Fridge/Freezer is designed to operate on DC voltage inputs.)

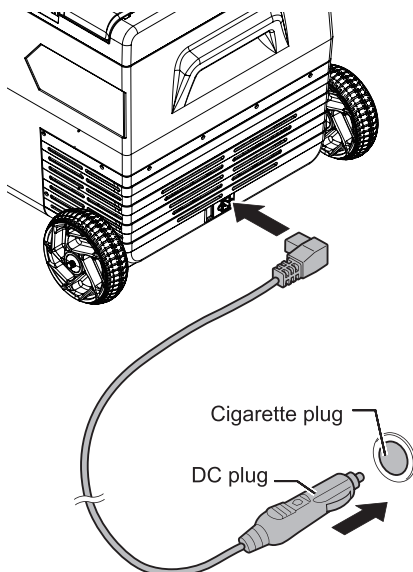

### NOTICE:



The DC interface at both ends of the product cannot be connected to the power supply at the same time.

# GETTING STARTED



## Some Reminders

1. If the device was not placed in the upright position after transit and delivery, **please keep it upright for 24 hours** to make sure that the compressor can work properly.
2. If the device can't turn on or you encounter other problems for first time use, please contact us for help.
3. **Pre-cool** the empty unit before using it to enhance system efficiency.

## SINGLE ZONE OPERATION

DSP-50AY1(MK)  
DSP-65AY1(MK)



In the standby status, short press “” to turn on the fridge. Short press “” to power off.

## ADJUSTING THE TEMPERATURE:

- When the appliance on, short press “ + ” button can up and down the temperature.
- Long press “ + ” or “ - ”, can adjust the temperature at 3°C per seconds.

## SWAPPING BETWEEN BATTERY ,FAHRENHEIT (°F) & CELSIUS (°C):



- In the standby status, long press “ + ” and “ - ” button at the same time for 3 seconds can enter Advanced Setting, When the Advanced setting comes up, short press “” button to cycle into pro mode (battery protection), or F/C function (Fahrenheit/Celsius switch mode)
- With the F/C function, short press “ + ” or “ - ” can convert Celsius to Fahrenheit. F refers to Fahrenheit, C refers to Celsius.
- With battery protection mode enabled, short press “ + ” or “ - ” will set the below voltage protection levels.

Battery protection Level

Battery protection (SWITCH POSITION)	Cut-out 12V	Cut-in 12V	Cut-out 24V	Cut-in 24V
LOW	9.6	10.9	21.3	22.7
MED	10.4	11.7	22.8	24.2
HIGH	11.1	12.4	24.3	25.7

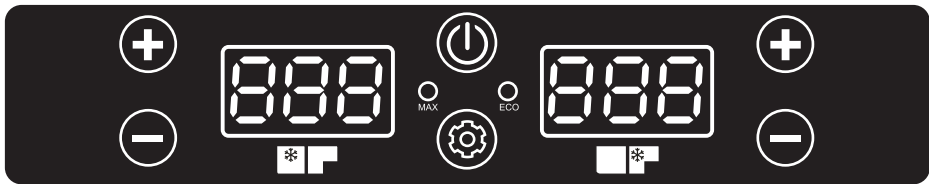
# DUAL ZONE OPERATION



In the standby status, short press “” to turn on the fridge. Short press “” to power off.

## ADJUSTING THE TEMPERATURE:

- Adjusting the temperature setting of the left box: in the start-up state, press the “ + ” or “ - ” button shortly to set up and down of the preset temperature of the left box. Press and hold the “ + ” or “ - ” button to adjust the preset temperature linearly with the speed.
- Adjusting the temperature setting of the right box: in the start-up state, press the “ + ” or “ - ” button to set up and down of the preset temperature of the right box. Press and hold the “ + ” or “ - ” button, and the preset temperature is adjusted linearly at 4°C per seconds.

## FASTER COOLING (MAX) & EFFICIENT COOLING (ECO) SETTINGS:

- Press the “” to switch between the ECO and MAX settings. The indicator light will illuminate next to the selected mode, red (MAX) or green (ECO).

## SWAPPING BETWEEN BATTERY ,FAHRENHEIT (°F) & CELSIUS (°C):

- In the standby status, long press “ + ” and “ - ” button at the same time for 3 seconds can enter Advanced Setting, When the Advanced setting comes up, short press “” button to cycle into pro mode (battery protection), or F/C function (Fahrenheit/Celsius switch mode)
- With the F/C function, short press “ + ” or “ - ” can convert Celsius to Fahrenheit. F refers to Fahrenheit, C refers to Celsius.
- With battery protection mode enabled, short press “ + ” or “ - ” will set the below voltage protection levels.

Battery protection Level

Battery protection (SWITCH POSITION)	Cut-out 12V	Cut-in 12V	Cut-out 24V	Cut-in 24V
LOW	9.6	10.9	21.3	22.7
MED	10.4	11.7	22.8	24.2
HIGH	11.1	12.4	24.3	25.7

# TROUBLESHOOTING

Code	Description	Action
E1	Battery Voltage is low.	Check battery voltage and adjust Low Voltage Cut-Off as required.
E2	Fan failure / Frequent start-stop.	Contact point of sale to arrange further action.
E3	Compressor startup problems.	Check air vents are clear. Move fridge to cooler location (ambient temperature may be too high).
E4	Compressor's running speed fails to reach the requirements.	
E5	The model is overloading.	
E6	NTC failure(open circuit or short circuit)	
E9	Communication error between display panel and control board	Contact point of sale to arrange further action.

## DAIY MAINTENANCE AND ATTENTION

### Matters need attention

- Please use a wet cloth and warm water mixed with gentle non-abrasive detergents to clean the interior and exterior of your fridge.
- Please power off and unplug the unit before cleaning.
- Please use non-abrasive detergent to cleaning the interior/exterior of the fridge.
- Please don't scrap the interior of the fridge to defrost/de-ice the fridge.
- Please don't pressure-wash/spray the fridge with a running water hose.
- It is strictly forbidden to wash refrigerators directly with water in order to prevent the reduction of electrical insulation and rusting of metal parts.
- The following things can damage the coating and plastic parts, so they can not be used for cleaning: alkaline detergent, soap, abrasive powder, hot water, brush, n-Pentyl acetate, gasoline, alcohol.

### Maintenance of plastic parts

• To properly protect the door seals, we must always keep them clean. Avoid grease staining and deformation when using. If oil (animal or vegetable oil) is attached to the plastic parts in the box for a long time, the plastic is easy to aging or cracking, and gives off a bad smell. Therefore, we should form the habit of cleaning regularly.



UK	REP
----	-----

Company:YH Consulting Limited

Address: C/O YH Consulting Limited Office 147,Centurion House , London Road , Staines-upon-Thames , Surrey , TW18 4AX